

DeckWise® • The Ipe Clip® Fastener Company, LLC • 2111 58th Ave. E, Bradenton FL, 34203
 Phone: 941-896-9851 • Email: info@DeckWise.com • Web: www.DeckWise.com

Crafted from solid stainless steel, DeckWise® Hidden Siding Fasteners create a smooth, sleek and upscale look. The entire system is designed to significantly reduce cupping, twisting, and mold growth due to water penetration. The DeckWise® Hidden Siding Fastener system is perfect for both residential and commercial applications.

Materials needed to install rainscreen siding:

- Base board (1x6 PT Pine is typical)
- Vapor Barrier
- Level
- Rubber mallet or Hardwood Wrench™
- Chalk line
- Rainscreen Siding
- DeckWise® Hidden Siding Fasteners
- Stainless Steel Screws
- Cordless Drill
- Ipe Seal™ Hardwood End Grain Sealer
- Furring Strips (1x3 pine is typical)

Prior to installation:

- Calculate how much siding you will need based on the “Net Finished Dimensions” only.
- Rainscreen Siding must acclimate to your local climate.
- Use Ipe Seal™ to cover the ends of the grain of any freshly cut siding boards.

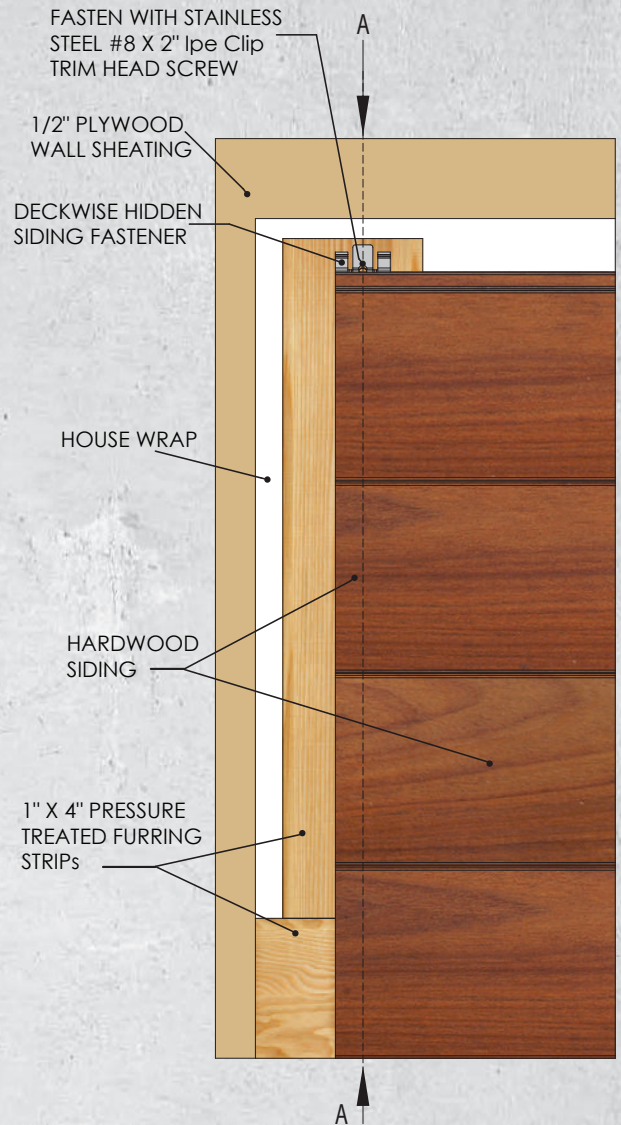

DeckWise® Hidden Siding Fastener Kit Contains:



Hidden Siding Fastener Kit Available in Quantities of 50, 175, 300 and 1050.

Hidden Siding Fasteners Installation Instructions



Step-by-step installation guide:

1. Install house wrap to prevent moisture intrusion.
(Always follow the vapor barrier manufacturer's instructions.)
2. Install the baseboard (horizontal furring strip) with stainless screws.
Ensure the baseboard is level.
3. Align furring strips vertically on top of baseboard 16" on center.
Attach furring strips.
4. Install starter clips (included with the hidden siding fastener kit) on your baseboard. Align each starter clip with the furring strips installed in step 3.
(TIP: use a chalk line reel to create a level line).
5. Install the first Rainscreen Siding board on top of the starter clips.
(TIP: Use a level to ensure this first board is aligned properly).
6. Place hidden siding fasteners into the pre-molded groove.
7. Drive a stainless steel screw through the siding fastener top hole into the furring strip at a 45 degree angle or, drive a stainless steel screw through the siding fastener bottom hole to penetrate both the siding board and the underlying furring strip, at a 45 degree angle.
8. Set the proceeding siding boards on top of the installed siding fasteners.
(TIP: Use a rubber mallet or the Hardwood Wrench™ to align boards properly and straight).

TIP: Where two pieces of siding butt against each other, use two hidden siding fasteners. (Use two starter clips if there is a butt joint with more than one piece of siding installed on the baseboard).

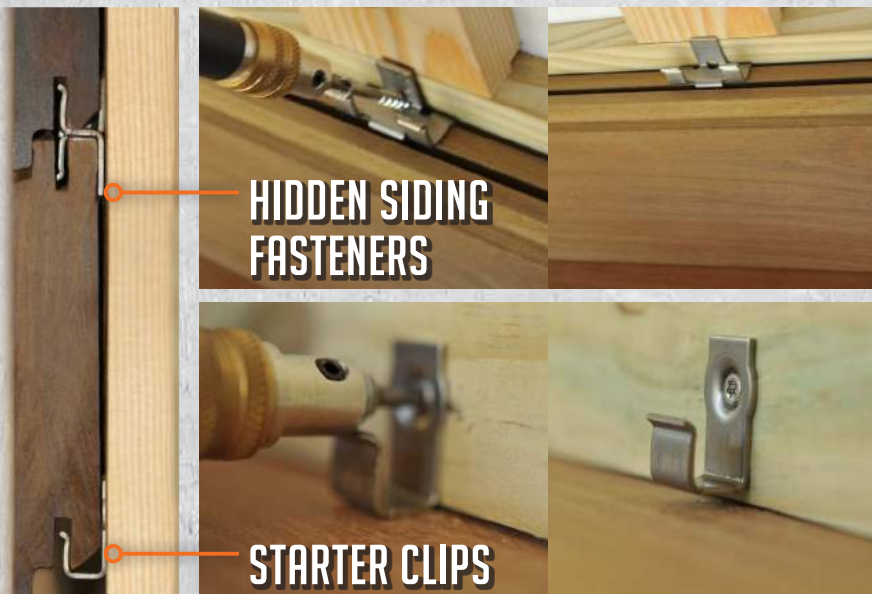

SCREW LOCATION IF HANGING SIDING ON THE VERTICAL, ANGULAR, OR OVERHEAD

